

Network Point #:	GF009-NP-001
Cable ID:	GF009-DTA-001
Cable Type:	Cat5a
Cable Length:	35m
Dist Zone:	DZ0
Patch#/ Port:	Ptch01/01

Network Point #:	GF009-NP-002
Cable ID:	GF009-DTA-002
Cable Type:	Cat5a
Cable Length:	35m
Dist Zone:	DZ0
Patch#/ Port:	Ptch01/02

Coax Point #:	GF009-TV-001
Cable ID:	GF009-COAX-001
Cable Type:	WF100
Cable Length:	35m
Dist Zone:	DZ0
Patch/Port:	CP01/01

Coax Point #:	GF009-TV-002
Cable ID:	GF009-COAX-002
Cable Type:	WF100
Cable Length:	35m
Dist Zone:	DZ0
Patch/Port:	CP01/02

Line Level Point #:	GF009-LINE-001
Cable ID:	GF009-LINE-001
Cable Type:	Line Level - Stereo
Cable Length:	35m
Dist Zone:	DZ0
Device From:	N/A

Coax Point #:	GF014-TV-001
Cable ID:	GF014-COAX-001
Cable Type:	WF100
Cable Length:	55m
Dist Zone:	DZ0
Patch/Port:	CP01/05

Coax Point #:	GF014-TV-002
Cable ID:	GF014-COAX-002
Cable Type:	WF100
Cable Length:	55m
Dist Zone:	DZ0
Patch/Port:	CP01/06

Network Point #:	GF014-NP-001
Cable ID:	GF014-DTA-001
Cable Type:	Cat5a
Cable Length:	55m
Dist Zone:	DZ0
Patch#/ Port:	Ptch01/05

Network Point #:	GF014-NP-002
Cable ID:	GF014-DTA-002
Cable Type:	Cat5a
Cable Length:	55m
Dist Zone:	DZ0
Patch#/ Port:	Ptch01/06

Network Point #:	GF014-NP-003
Cable ID:	GF014-DTA-003
Cable Type:	Cat5a
Cable Length:	55m
Dist Zone:	DZ0
Patch#/ Port:	Ptch01/07

Telephone Point #:	GF014-TP-001
Cable ID:	GF014-TEL-001
Cable Type:	Cat5e
Cable Length:	55m
Dist Zone:	DZ0
Patch#/ Port:	NTE5 Master

Telephone Point #:	GF002-TP-001
Cable ID:	GF002-TEL-001
Cable Type:	Cat5e
Cable Length:	45m
Dist Zone:	DZ0
Patch/ Port:	NTE5 Master

Network Point #:	GF006-NP-001
Cable ID:	GF006-DTA-001
Cable Type:	Cat5a
Cable Length:	50m
Dist Zone:	DZ0
Patch#/ Port:	Ptch01/03

Network Point #:	GF006-NP-002
Cable ID:	GF006-DTA-002
Cable Type:	Cat5a
Cable Length:	50m
Dist Zone:	DZ0
Patch#/ Port:	Ptch01/04

Coax Point #:	GF006-TV-001
Cable ID:	GF006-COAX-001
Cable Type:	WF100
Cable Length:	50m
Dist Zone:	DZ0
Patch/Port:	CP01/03

Coax Point #:	GF006-TV-002
Cable ID:	GF006-COAX-002
Cable Type:	WF100
Cable Length:	50m
Dist Zone:	DZ0
Patch/Port:	CP01/04

Line Level Point #:	GF009-LINE-001
Cable ID:	GF009-LINE-001
Cable Type:	Line Level - Stereo
Cable Length:	50m
Dist Zone:	DZ0
Device From:	N/A

Network Point #:	GF002-SPNL-001
Cable ID:	GF002-DTA-001
Cable Type:	Cat5e
Cable Length:	45m
Dist Zone:	DZ0
Patch#/ Port:	Ptch01/08

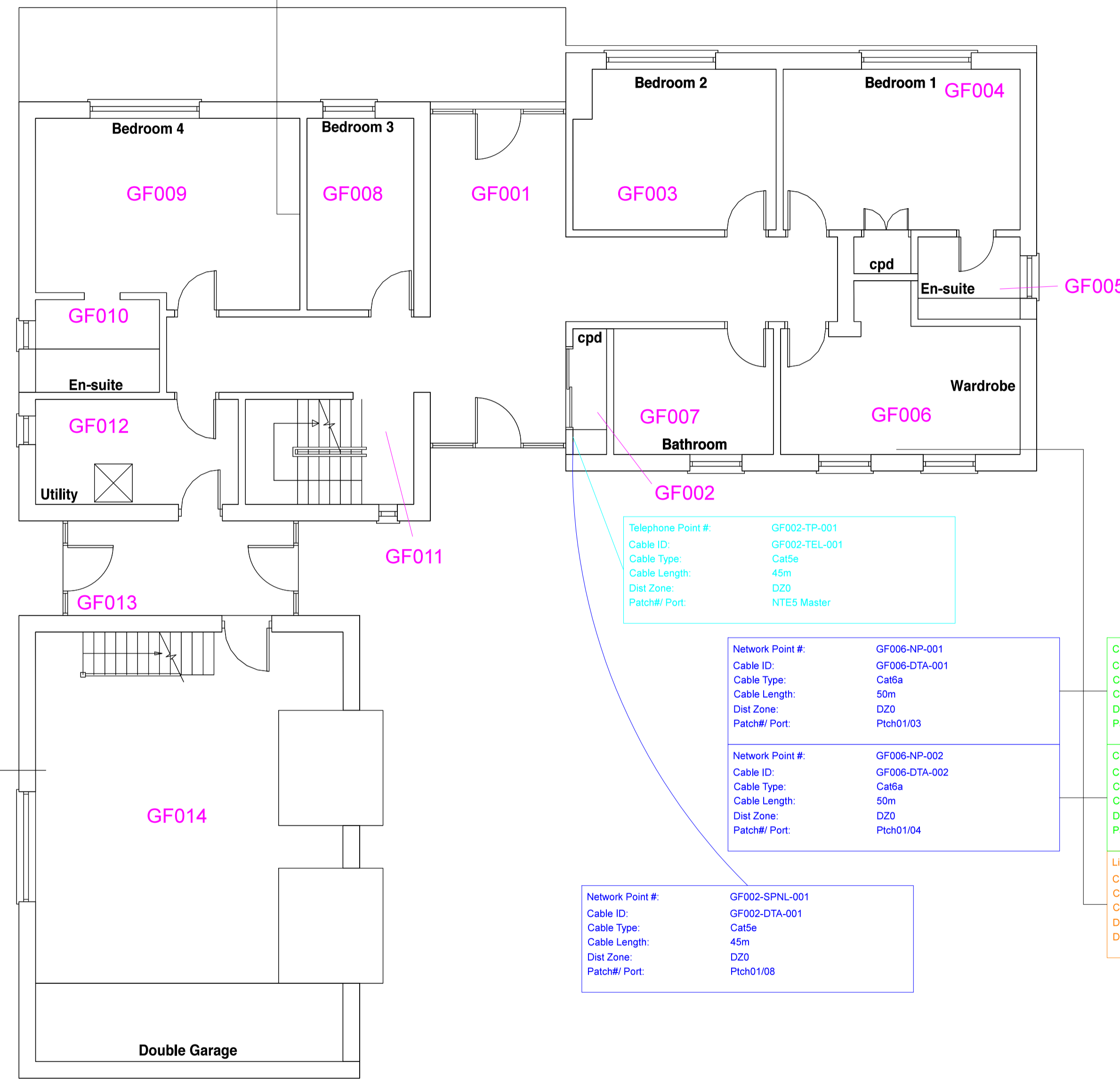

Ground Floor Plan

GF020

Client Notes
1. Check All Fittings & Locations Before 2nd Fix Begins.

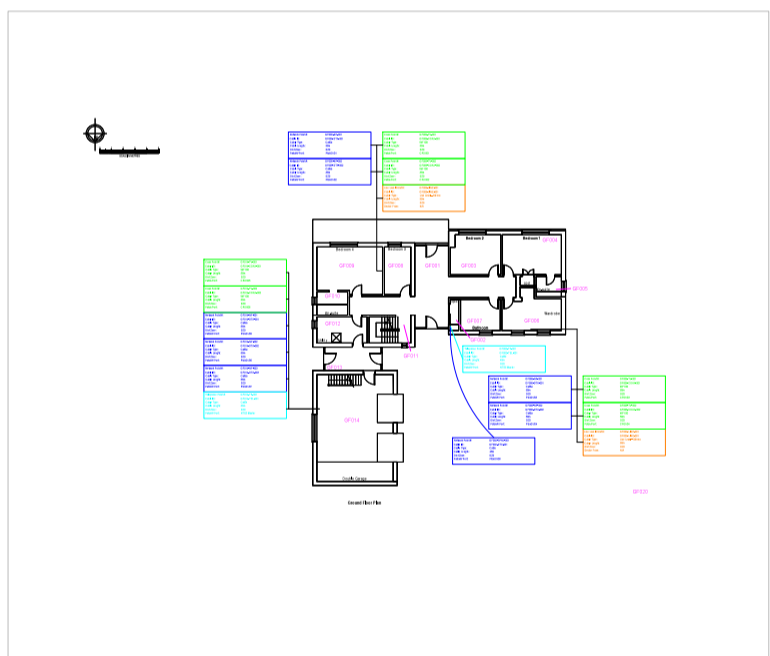

Client Works Name: _____
 Client Works Address: _____
 Mobile #: _____
 Email: _____

DO NOT SCALE FROM THIS DRAWING. DRAWING FOR ILLUSTRATION ONLY. ALL MEASUREMENTS TO BE TAKEN ON SITE. DO NOT USE FOR SITE WORKS.
 ILLUSTRATED LAYOUT OF THIS PROPERTY HAS BEEN TAKEN FROM ARCHITECT PLANS.
 ORIGINAL PLANS ARE COPYRIGHT OF THE ARCHITECT.

DRAWING CONTENT

Drawing #:	Drawing Date:
Drawing #:	Drawing Date:
Drawing #:	Drawing Date:
Ground Floor - COAX TV	30/10/2018
Ground Floor - Data	30/10/2018
Ground Floor - Line Level/IR	30/10/2018
Drawing #:	Drawing Date:
Drawing #:	Drawing Date:
Ground Floor - Telephone Points	30/10/2018
Drawing #:	Drawing Date:

Size:	Scale:	Designer:
A1	1 / 75	LI